

Starting your Successful Garden Course Workbook

Table of Contents:

1. Course Intro
 - Complete Worksheet
2. Choosing the RIGHT Location
 - Location Checklist
3. Garden Design
 - Quick Guide
 - Sample Garden Design Sketches
4. Construction
 - Helpful Tips from a Contractor
5. Site Preparation
 - Instructional Guide
6. Irrigation
 - Buyers Guide
7. Soil
 - Buyers Guide
8. Final Instructions
 - Helpful Tips
9. Garden Design Consultation
 - Graph Paper for Garden Designs (print more if needed)

Course Worksheet

(Please complete each part of this worksheet. We will confirm your answers during our Garden Design Consultation once you have completed the course)

Your Name

Your Garden Address

Note, we value your personal information. No 3rd parties will ever see your data. We only use your address to confirm the physical location of your garden during our Garden Design Consultation

Starter Questions:

Do you own your home or are you renting?

- Owner
- Renter

Have you grown food before or is this your first time?

- Grown Before
- First Time Gardener

What is your favorite vegetable?

Garden Design

Please select your Garden Style

Check ALL that apply

- Garden in the Ground
- Raised Bed Garden
- Container Garden

Why did you choose this style for your Garden?

Sizing Your Garden

Please fill in this section based on your favorite garden design sketch

We will use this information to help make your shopping list during the Garden Design Consultation

What are the dimensions of each planting area?

A planting area can be a section of in-ground garden, a container, or a raised bed. DO NOT include walking paths or surrounding areas. These are the areas you intend to fill with soil.

Area #	Length (inches)	Width (inches)	Height (inches)
Area 1	24	48	12
Area 2			
Area 3			
Area 4			
Area 5			
Area 6			
Area 7			
Area 8			

Construction

What materials will you use to build your garden?

- Wood
- Metal
- Stone
- Composite
- Other

Choosing the Right Location

On-Site Checklist

S.O.I.L.S - Test

Sunlight

- Garden location gets 8 hours of direct sunlight / day.
If not, how many hours of sunlight each day? _____
- Location is free from large shade-causing obstructions on the SOUTH SIDE (ex: 2 story house, large trees, nearby building)

Observability

- Can you see the garden location from inside your house?
- Which of these have you observed visiting your garden area?

<input type="checkbox"/> Rodents	<input type="checkbox"/> Birds	<input type="checkbox"/> Deer	<input type="checkbox"/> Other _____
----------------------------------	--------------------------------	-------------------------------	--------------------------------------

Irrigation

- There is a water source near my garden location

<input type="checkbox"/> Hose Outlet	<input type="checkbox"/> Irrigation Valves	<input type="checkbox"/> Water Tank	<input type="checkbox"/> Other _____
--------------------------------------	--	-------------------------------------	--------------------------------------

Level Ground

- Garden area is on a level surface

Security

- Garden Area is surrounded by a fence
- You see NO evidence of underground rodents in the area
- Garden Area is defendable from pests you have observed in the area

Garden Design

Quick Guide

A few simple rules for creating a great garden design:

1) Decide how much food you want to produce

- Each person in a household will consume ~50 square feet of produce grown in a home garden each year.

2) Decide how much time you want to dedicate to your garden each week

- A garden with a functional design does not require a huge time commitment.
- Example: a 50 square foot garden requires about 15 mins of maintenance at least 2X / Week (30 mins / week).

3) Find out the Total available square feet in your proposed garden location

- Multiply the length and width of your proposed garden location to determine how much space you have to work with.
- Around 60% of your available space will be used to determine your actual garden area square footage.
- Likely around 40% will be used for walking paths creating good access to your garden area.

4) Don't worry about the North-South orientation of your growing areas

- Your raised-beds / containers / in-ground garden can be drawn East-West or even diagonal.
- When you plant your garden for the first time, the plants you choose will determine the importance of orientation.

5) Have fun with your design!

- Don't be afraid to dream. Draw elaborate plans and include for future expansions of your garden.

Construction Materials

A Contractor's INSIDER Guide

- Consolidating your orders and buying from a single vendor / distributor will open up more bargaining power than ordering from many different vendors.
- Build your garden STRONG! Don't cut corners or "build cheap" because it won't last. It's worth spending a little extra money for a garden that will last.
- Compare these prices to quotes from local contractors...

StartOrganic Pricing Examples for Redwood Raised Garden Beds (from 2018)

Size of Raised Bed	How much Soil you need (cubic feet)	Price (Including: Lumber, Soil, Irrigation, Delivery+ Installation)
2' x 4' x 12"	8	\$999.00
3' x 3' x 12"	9	\$1099.00
4' x 4' x 12"	16	\$1299.00
4' x 8' x 12"	32	\$1699.00
2' x 4' x 18"	12	\$1199.00
3' x 3' x 18"	13.5	\$1299.00
4' x 4' x 18"	24	\$1499.00
4' x 8' x 18"	48	\$1899.00
2' x 4' x 24"	16	\$1399.00
3' x 3' x 24"	18	\$1499.00
4' x 4' x 24"	32	\$1699.00
4' x 8' x 24"	64	\$2099.00

Design #1 (Simple with Raised beds)

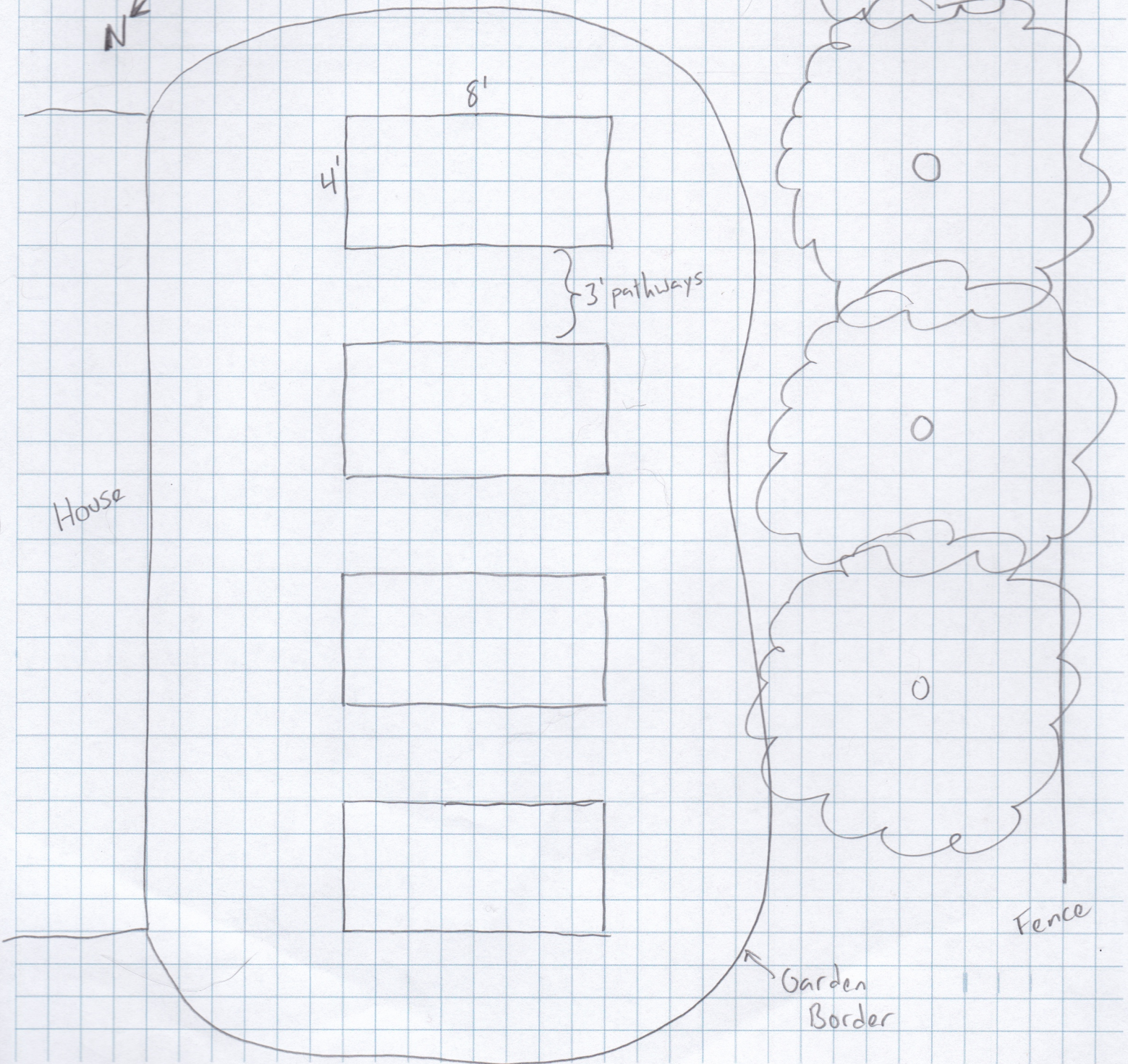
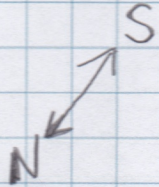

Design #2

(Patio with Containers)

S
↑
N

Wine
Barrels

Square Containers

Patio

House

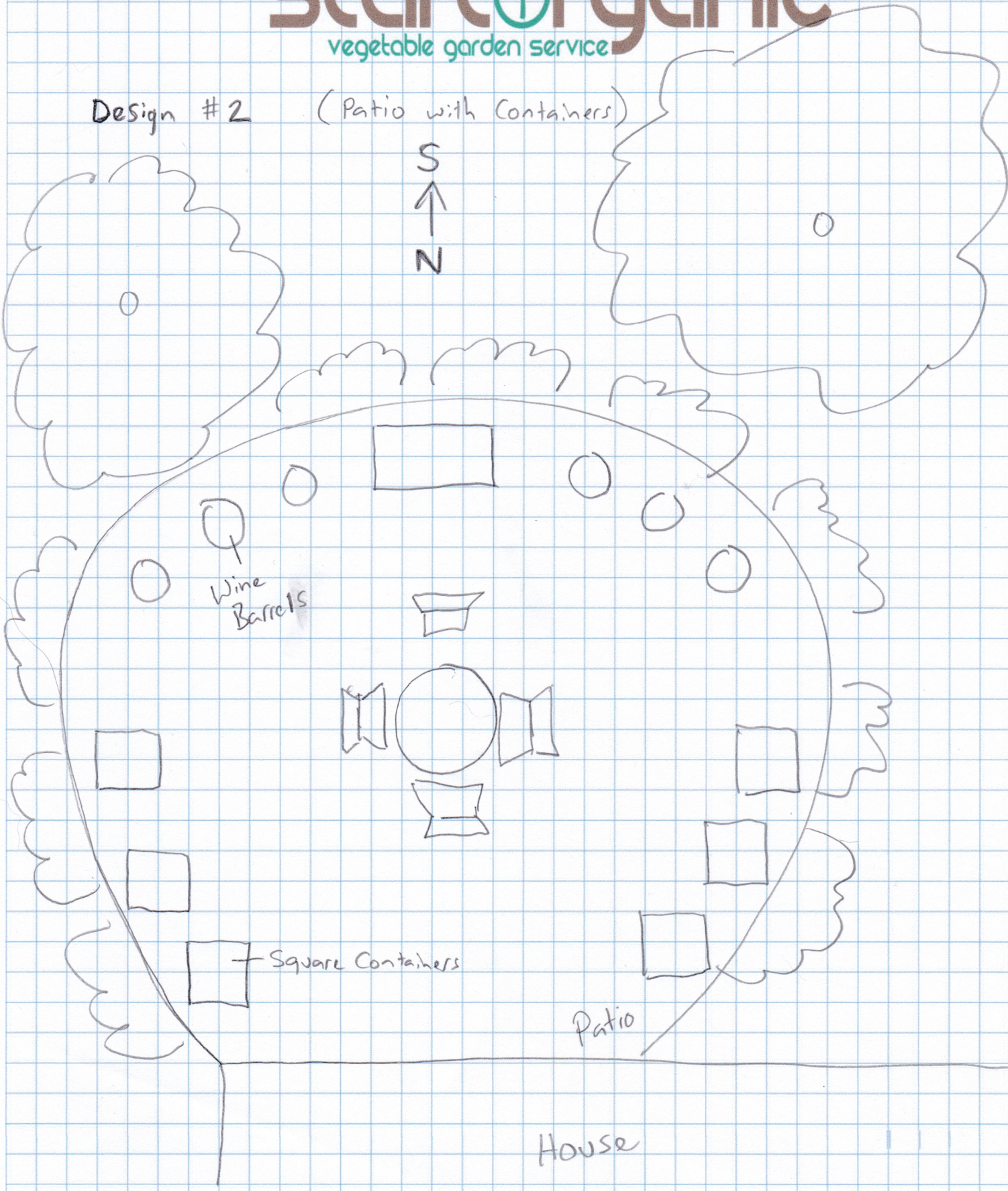

Design # 3 (Garden in the ground)

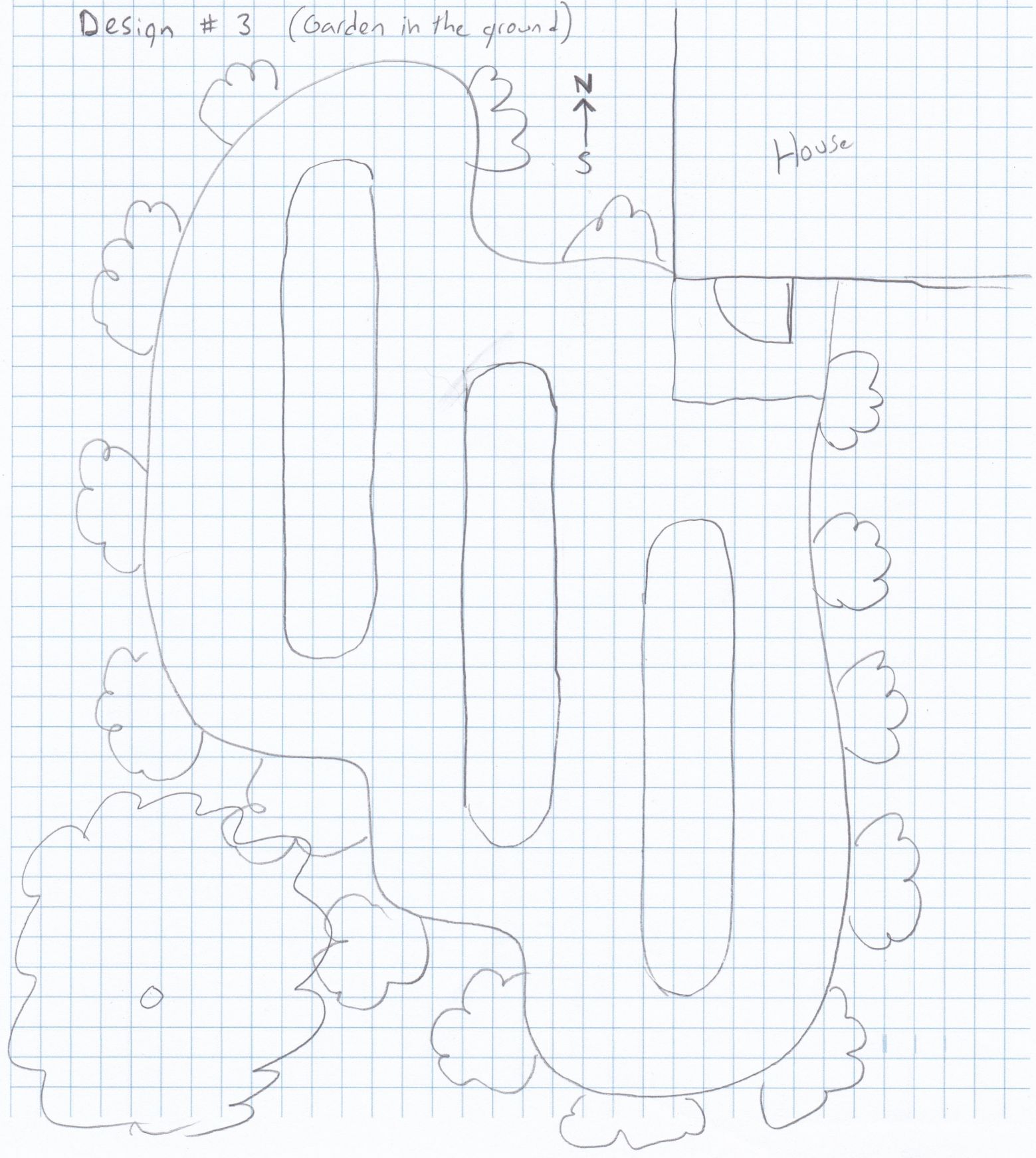

Site Preparation

Instructional Guide

Carry this guide with you when you are ready to begin construction on your garden

1) Determine the composition and compaction of your native soil.

- Dig 2-3 sample holes in your garden area
- Each hole should be at least 8" deep and 8" wide
- Note the composition of the soil you remove from the hole (rocky, sandy, clay etc)
- Fill each empty hole with water from a hose
- Observe how long it takes for the water to drain from the hole
- If water drains quickly, you have well-draining soil
- If water remains in the hole the following morning your soil is heavily compacted

2) Prepare the site for your new garden.

- In each of your growing areas, (whether you are growing in raised beds or in-the-ground) break up the compacted soil to a depth of 6".
- Remove the largest rocks from the area. Break all chunks of clay soil down to under 2" pieces.
- You do not need to prepare the soil in pathway areas (only areas you will be actively growing). Go ahead and compact the pathway areas by walking in them repeatedly.
- Using a rototiller can be helpful for areas larger than 50 square feet. Machine tillers shred and kill earthworms and other soil organisms. Using hand tools can be beneficial.

Irrigation Materials

Buyer's Guide

Timer options	
Simple: Battery Operated Timer on Hose Outlet	https://www.homedepot.com/p/Orbit-1-Port-Single-Dial-Timer-62056/100126132
Better: Wifi Battery Timer on Hose Outlet (Option 1 - based on reviews)	https://www.amazon.com/Zilker-Water-Hose-Faucet-Timer/dp/B07L6SL9P5/ref=as_li_ss_tl?creativeASIN=B07L6SL9P5&imprToken=W6rsd6q26P5WQH18EWIIVw&slotNum=11&encoding=UTF8&pd_rd_i=B07L6SL9P5&pd_rd_r=435e4072-6575-11e9-b475-c358acaaf9b4&pd_rd_w=ajzy8&pd_rd_wg=O2utS&pf_rd_p=ad07871c-e646-4161-82c7-5ed0d4c85b07&pf_rd_r=7WARXHQ137N5ERSTRAVB&pvc=1&refRID=7WARXHQ137N5ERSTRAVB&linkCode=sl1&tag=outsidemod08-20&linkId=f736337a81eb01d44a81fca20b5b4392&language=en_US
Better: Wifi Battery Timer on Hose Outlet (Option 2 - based on reviews)	https://www.homedepot.com/p/Orbit-B-Hyve-Smart-Hose-Faucet-Irrigation-Controller-Wi-Fi-Hub-21830/312203262
Best: Wifi Timer on Irrigation Valves (requires installation skills)	https://www.homedepot.com/p/Scotts-Gro-7-Zone-Controller-Smart-Sprinkler-7-Zone-Sprinkler-Irrigation-Controller-Wifi-Enabled-Remote-Access-70001-1/302953648
Distribution options	
Simple: 1/2" Polytube (100')	https://www.homedepot.com/p/Advanced-Drainage-Systems-1-2-in-x-100-ft-IPS-100-PSI-UTY-Poly-Pipe-05100100/203294377
Advanced: 1/2" PVC (requires installation skills)	https://www.homedepot.com/p/1-2-in-x-10-ft-600-PSI-Schedule-40-PVC-Plain-End-Pipe-530048/100113200
Water Delivery System	
For all applications: 1/4" drip irrigation with 6" emitter spacing	https://www.homedepot.com/p/Rain-Bird-1-4-in-x-50-ft-Emitter-Tubing-with-6-in-Spacing-ET256-50S/205640047

Add-Ons (necessary for assembly of irrigation system)	
Connectors from 1/2" polytube to 1/4" drip lines	https://www.homedepot.com/p/DIG-1-4-in-Barb-Connectors-10-Pack-H80A/100114529?MERCH=REC-_pipinstock_-300839280_-100114529_-N
Goof plugs to close the ends of 1/4" drip lines	https://www.homedepot.com/p/DIG-Goof-Plugs-20-Pack-G79B/100126681
Landscape Staples - to anchor the drip lines	https://www.homedepot.com/p/Glamos-Wire-6-in-Square-Landscape-Staple-1000-Pack-83000/312209736
Main connection from Battery Timer to 1/2" Polytube (option 1 - Brass)	https://www.homedepot.com/p/Bon-Tool-5-8-in-Shank-Hose-Coupling-Female-Only-84-318/304286512
Main connection from Battery Timer to 1/2" Polytube (option 2 - Plastic)	https://www.homedepot.com/p/DIG-3-4-in-Female-Hose-Thread-x-1-2-in-0-700-O-D-Compression-Swivel-Adapter-C34/100141505?MERCH=REC-_plpsearch_multi_-NA_-100141505_-N

Soil Materials

Buyer's Guide

- Source LOCAL Materials - They will be more "alive" and better for your garden.
- Reminder: Choose materials with a DIVERSE set of ingredients (different materials mixed together will generally perform better than a single ingredient soil)
- Here's some simple rules that will help you save money on buying quality soil...

BAGGED SOIL	BULK SOIL
Costs between \$4 - \$9 per Cubic Foot (Average: \$6.50 / Cubic Foot)	Costs between \$50 - \$90 per Cubic Yard (27 Cubic Feet in a Cubic Yard) (Average: \$2.60 / Cubic Foot)
Bagged Soil Can be picked up in-person and does not usually require delivery	Bulk Soil is TOO HEAVY to pick up in person and will require delivery (usually a one-time charge of \$60)
If your garden requires LESS than 27 Cubic Feet (OR 1 Cubic Yard) you'll likely choose BAGGED Soil	If your garden requires MORE than 27 Cubic Feet (OR 1 Cubic Yard) you'll likely choose BULK Soil Delivery
Your average car will only hold the weight of UNDER 20 cubic feet per load	Bulk Soils are Delivered and DUMPED in the area of your choosing (usually your driveway)

Examples (garden size)	Cubic Feet Needed	Bagged Soil Cost	Bulk Soil Cost
(1) Raised Bed 4' x 4' x 12"	16	\$104.00	\$42 Soil + \$60 Delivery = \$102
(2) Raised Beds 3' x 6' x 18"	54	\$351.00	\$140 Soil + \$60 Delivery = \$200
(3) Raised Beds 4' x 8' x 18"	144	\$936.00	\$374 Soil + \$60 Delivery = \$434

Note: We will confirm the quantities for your soil order during our Garden Consultation

Final Instructions

Helpful Tips

- Draw and PLAN your Garden WELL before you start ordering materials and building! This garden will be a big part of your life over time.
- Don't be afraid to start SMALL and give yourself time to GROW. Try starting with a PLAN that gives you room to expand your garden over time. Example: Most of our clients over the years started with around 50 square feet in their first garden. Over the following years, they expanded by 30-40 square feet per year. Finally, after 5-6 years, they had a garden large enough to feed their entire family (with Extras)
- Gardens are SEASONAL. You'll need to PLAN to plant your garden each season with the right veggie options. There are better times to plant than others. Check out our seasonal courses for complete PLANTING GUIDES and instructions.
- There is a good deal of information to take in and process. Take each step ONE AT A TIME and you'll do great.

You'll be a great gardener in no time:

YOU GOT THIS!







