

- Included in panel project kit:**
- (2) Nylon Loop Clamp Black .25in
 - (1) Rubber Grommet
 - (10) Short Pull Rivets
 - (2) Long Pull Rivets
 - (1) AA Battery Holder
 - (1) 4 Terminal Buss Block
 - (2) Lamp Sockets E10 Vert Mount Socket
 - (1) Electrical Panel Base
 - (2) Electrical Panel Front

NOT included: Manual Rivet Gun (can be purchased for around \$10 in most tool shops)

Our SportAir panel projects are shipped disassembled. Minor assembly required to begin your electric panel project. Follow the easy steps below to complete assembly.

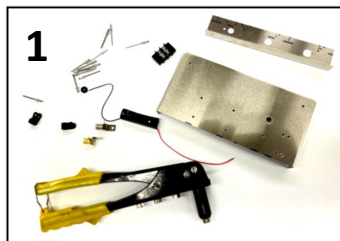

Step 1: Gather parts for panel project (see picture)

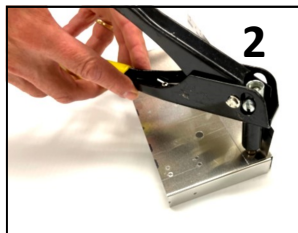

Step 2: Install **Electrical Panel Front** onto **Electrical Panel Base** with **2 Short Pull Rivets** using the Manual Rivet Gun

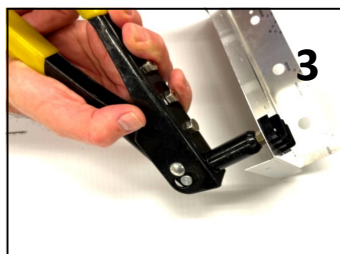

Step 3: Install **Bus Block** onto **Electrical Panel Base** with **2 Long Pull Rivets** on opposite corners

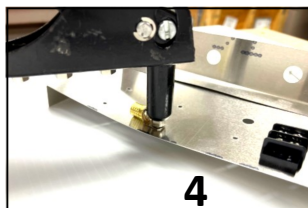

Step 4: Install both **Lamp Sockets** to **Electrical Panel Base** with **2 Short Pull Rivets** (1 Rivet each)

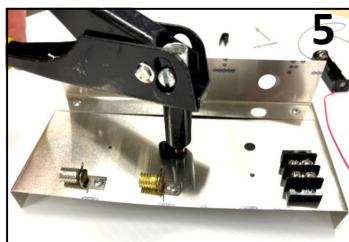

Step 5: Install both **Nylon Loop Clamps** with **2 Short Pull Rivets** (1 Rivet each)

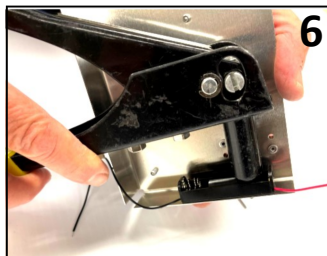

Step 6: Install **AA Battery Holder** onto bottom side of the **Electrical Panel Base**

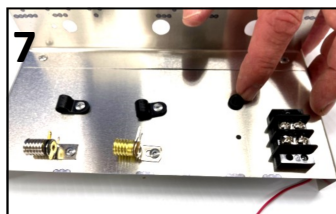

Step 7: Install **Rubber Grommet** into the large hole in the **Electrical Panel Base**

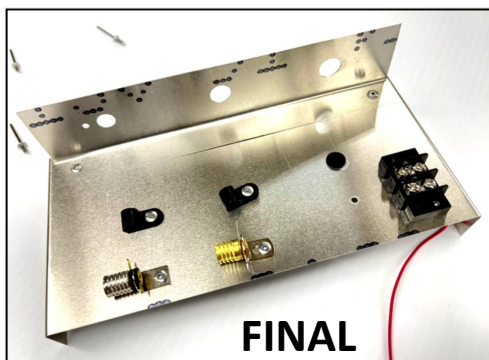

You have now completed the assembly of the panel project. You may continue to the electrical panel project