

QSG-PSE2018-manual



Quick Start Guide for Photoshop Elements 2018

Program, Panels, Preferences & Tool Options
Manual

Get in sync with your Digital Scrapper instructor right from the get go with our Quick Start Guide.

© 2020 Digital Scrapper

[Terms of Use](#)

Start From the Beginning (optional)

- Press Ctrl K (Mac: Cmd K) to open Preferences.
- In the General tab, click Reset Preferences on Next Launch.

NOTE: Resetting Preferences will not remove previously installed styles or actions.

- Click OK to the warning dialog.
- Click OK to close Preferences.
- Close Photoshop Elements and relaunch.

Basic Setup

- Click on Expert Mode.
- In the Menu Bar, choose File > New > Blank File. The settings of this file are irrelevant.
- In the dialog box, click OK.
- Right click (Mac: Ctrl click) on a gray area of the viewing area to get a menu and choose Default. If you don't see any gray area, Press Ctrl - (Mac: Cmd -) to zoom out.

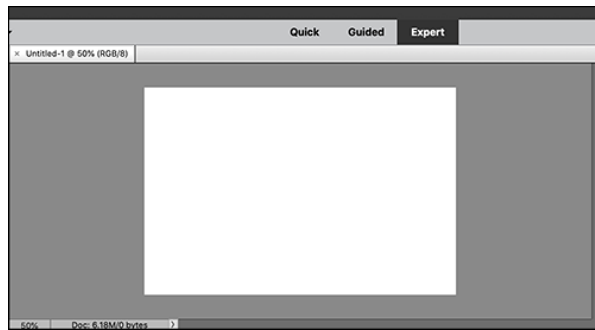

Custom Workspace

- In the bottom corner of the program, click the arrow next to More and choose Custom Workspace.

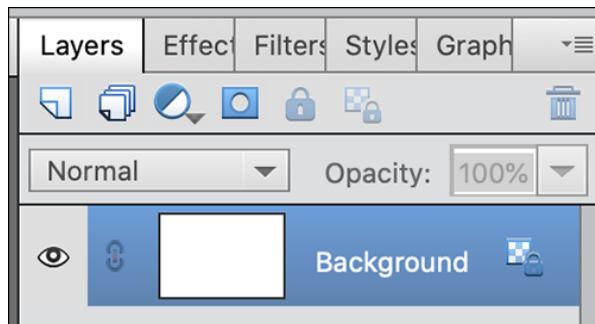

- Right click (Mac: Ctrl click) on the Effect panel and choose Close.
- Repeat to close the Filter panel, Styles panel, and Graphics panel.

NOTE: To open new panels, in the Menu Bar, choose Window and choose a panel to open.

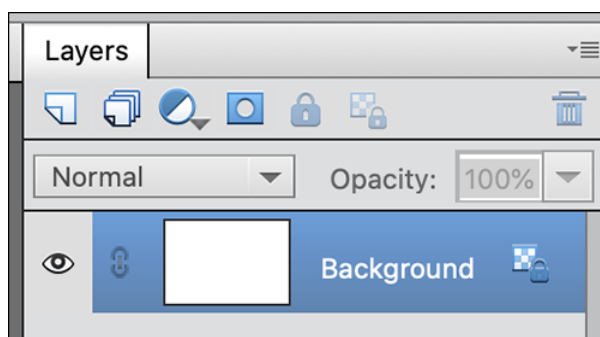

Tool Options

- Get the Move tool.

- In the Tool Options, click on the flyout menu (it's indicated with 4 horizontal bars) and uncheck Auto Show Tool Options.

NOTE: To open and close Tool Options, click on the Tool Options icon.

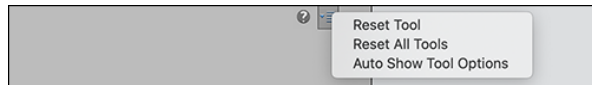

Layers Panel

- In the Layers panel, click on the flyout menu and choose Panel Options.
- In the dialog box, set the Thumbnail Size to Medium, the Thumbnail Contents to Layer Bounds, and uncheck Use Default Masks on Fill Layers. Click OK.

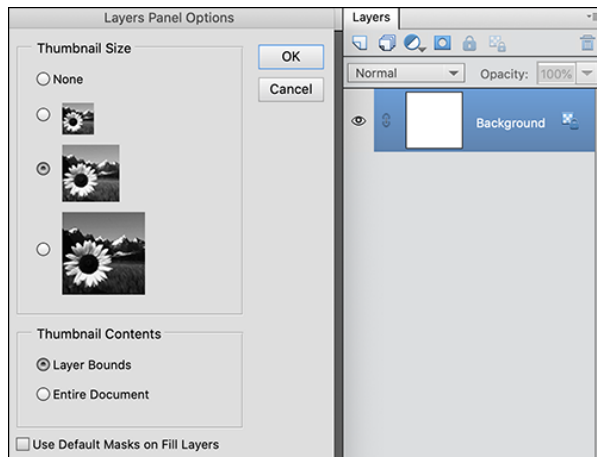

Preferences

- Press Ctrl K (Mac: Cmd K) to open Preferences.
 - In General, leave all the settings as shown (they are default settings) except:
 - Check Disable Smart Objects.
 - Uncheck Select Move Tool After Committing Text.
- NOTE: As of January 2021, Select Move Tool remains checked in PSE Videos
- Check Allow Floating Documents in Expert Mode.
 - Check Use Shift Key for Tool Switch.
 - Click OK to commit the changes.

Move Tool Tool Options

- Get the Move tool.
- In the Tool Options, uncheck Auto Select Layer and check Show Bounding Box.

Move	Arrange	Align	Distribute
<input type="checkbox"/> Auto Select Layer <input checked="" type="checkbox"/> Show Bounding Box <input type="checkbox"/> Show Highlight on Rollover		<div> <div>Top</div> <div>Center</div> <div>Bottom</div> </div> <div> <div>Left</div> <div>Middle</div> <div>Right</div> </div>	<div> <div>Top</div> <div>Center</div> <div>Bottom</div> </div> <div> <div>Left</div> <div>Middle</div> <div>Right</div> </div>

Preferences

General

Color Picker: Adobe

Step Back/Fwd: Cmd+Z / Cmd+Y

Options

☒ Show Tool Tips
☒ Disable Smart Objects
☐ Select Move tool after committing text
☒ Allow Floating Documents in Expert Mode
☒ Enable Floating Document Window Docking

☒ Use Shift Key for Tool Switch
☐ Zoom with Scroll Wheel
☐ Enable Soft Notifications
☐ Enable Crop Pre-Selection

Reset Preferences on next launch

Reset All Warning Dialogs

Reset Auto Smart Tone Learning

OK Cancel Reset Prev Next

Preferences

General

Saving Files

File Saving Options

On First Save: Ask If Original

Image Previews: Always Save

☒ Thumbnail

File Extension: Use Lower Case

☒ Save As to Original Folder

File Compatibility

☐ Ignore Camera Data (EXIF) profiles

Maximize PSD File Compatibility: Always

Recent file list contains: 20 files

OK Cancel Reset Prev Next

Preferences

General

Performance

Memory Usage

Available RAM: 30042 MB

Ideal Range: 16523-21630 MB

Let Photoshop Elements Use: 21029 MB (70%)

Graphics Processor Settings

Detected Graphics Processor:

ATI Technologies Inc.

AMD Radeon R9 M395 OpenGL Engine

☒ Use Graphics Processor for Adjusting Facial Features

History & Cache

History States: 50

Cache Levels: 6

Description

OK Cancel Reset Prev Next

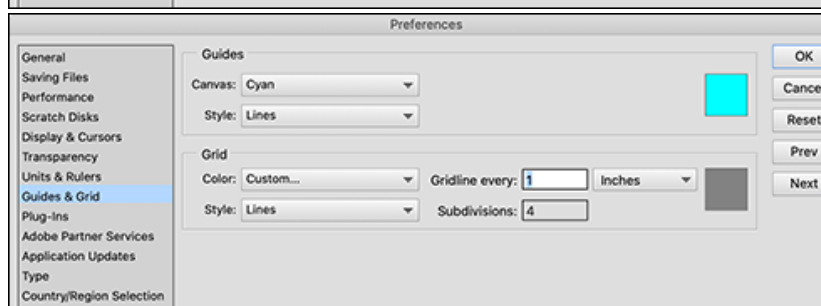
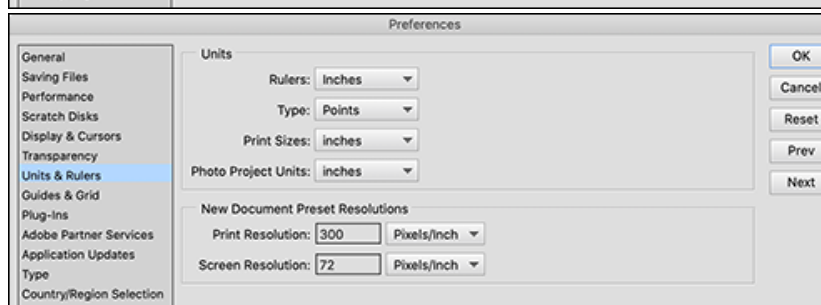
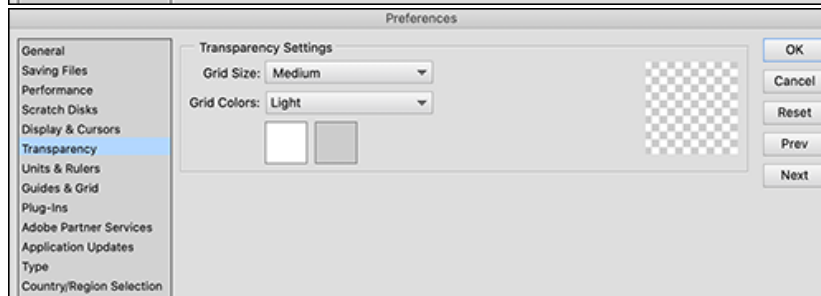
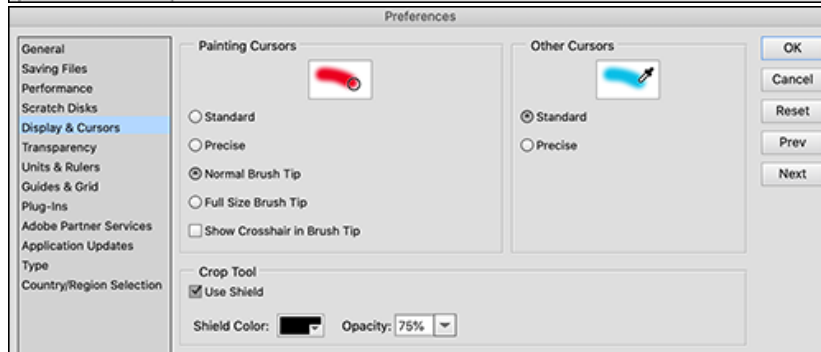
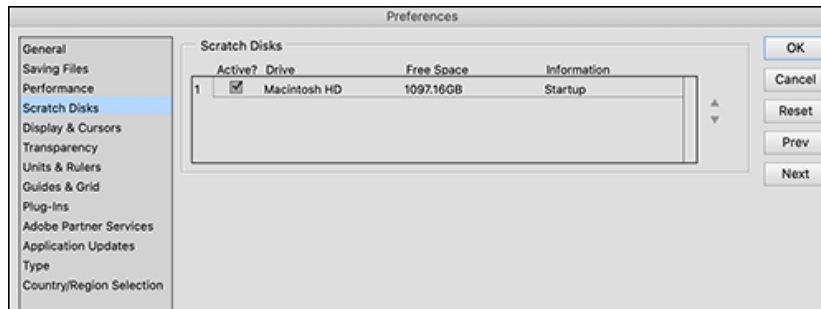

Preferences

General
Saving Files
Performance
Scratch Disks
Display & Cursors
Transparency
Units & Rulers
Guides & Grid
Plug-Ins
Adobe Partner Services
Application Updates
Type
Country/Region Selection

☐ Additional Plug-Ins Folder

<None> Choose...

OK
Cancel
Reset
Prev
Next

Preferences

General
Saving Files
Performance
Scratch Disks
Display & Cursors
Transparency
Units & Rulers
Guides & Grid
Plug-Ins
Adobe Partner Services
Application Updates
Type
Country/Region Selection

Check For Services

☒ Automatically check for services

Refresh Manually check for new services

Settings

Reset Accounts Reset stored account information for all services

Clear Online Services Data Clear stored online service data

OK
Cancel
Reset
Prev
Next

Preferences

General
Saving Files
Performance
Scratch Disks
Display & Cursors
Transparency
Units & Rulers
Guides & Grid
Plug-Ins
Adobe Partner Services
Application Updates
Type
Country/Region Selection

Update Preferences

☐ Automatically download and install updates

☒ Notify me when an update is available

OK
Cancel
Reset
Prev
Next

Preferences

General
Saving Files
Performance
Scratch Disks
Display & Cursors
Transparency
Units & Rulers
Guides & Grid
Plug-Ins
Adobe Partner Services
Application Updates
Type
Country/Region Selection

Type Options

☒ Use Smart Quotes

☐ Show Asian Text Options

☒ Enable Missing Glyph Protection

☒ Show Font Names in English

☒ Font Preview Size: Medium

OK
Cancel
Reset
Prev
Next

Preferences

General
Saving Files
Performance
Scratch Disks
Display & Cursors
Transparency
Units & Rulers
Guides & Grid
Plug-Ins
Adobe Partner Services
Application Updates
Type
Country/Region Selection

Country/Region Selection

Please select your Country/Region: United States

OK
Cancel
Reset
Prev
Next