

QSG-PSE2021-manual



Quick Start Guide for Photoshop Elements 2021

Program, Panels, Preferences & Tools
Manual

Get in sync with your Digital Scrapper instructor right from the get go with our Quick Start Guide for Photoshop Elements 2021.

© 2020 Digital Scrapper

[Terms of Use](#)

Start From the Beginning (optional)

- Press Ctrl K (Mac: Cmd K) to open Preferences.
- In the General tab, click Reset Preferences on Next Launch.

NOTE: Resetting Preferences will not remove previously installed styles or actions.

- Click OK to the warning dialog.
- Click OK to close Preferences.
- Close Photoshop Elements and relaunch.

Basic Setup

- Click on Expert Mode.
- In the Menu Bar, choose File > New > Blank File. The settings of this file are irrelevant.
- In the dialog box, click OK.
- Right click (Mac: Ctrl click) on a gray area of the viewing area to get a menu and choose Default. If you don't see any gray area, Press Ctrl - (Mac: Cmd -) to zoom out.

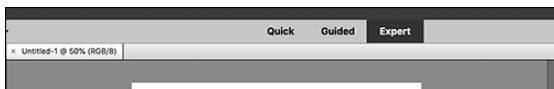



Custom Workspace

- In the bottom corner of the program, click the arrow next to More and choose Custom Workspace.

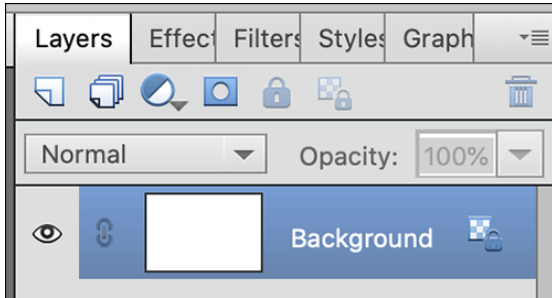

- Right click (Mac: Ctrl click) on the Effects panel and choose Close.
- Repeat to close the Filters panel, Styles panel, and Graphics panel.

NOTE: To open new panels, in the Menu Bar, choose Window and choose a panel to open.

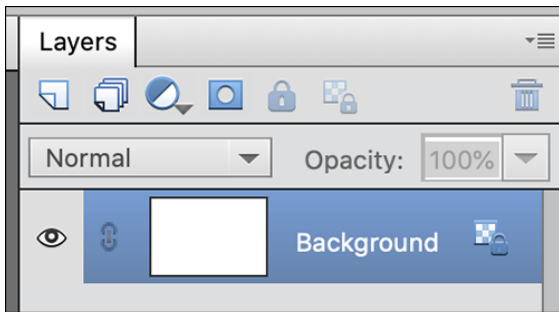

- Click and drag the left edge of the Layers panel to the left as far as it will go.

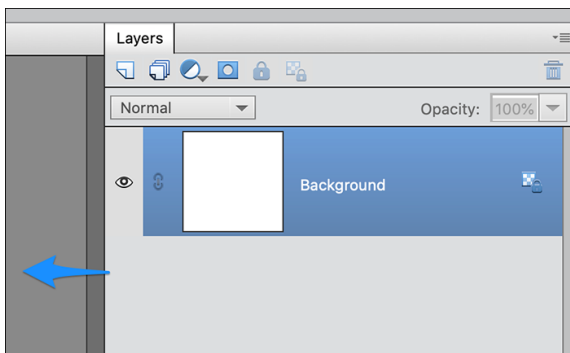

Tool Options

- Get the Move tool.
- In the Tool Options, click on the flyout menu (it's indicated with 4 horizontal bars) and uncheck Auto Show Tool Options.

NOTE: To open and close Tool Options, click on the Tool Options icon.

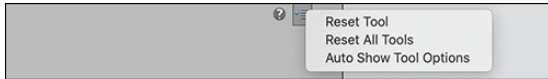

Layers Panel

- In the Layers panel, click on the flyout menu and choose Panel Options.
- In the dialog box, set the Thumbnail Size to Medium, the Thumbnail Contents to Layer Bounds, and uncheck Use Default Masks on Fill Layers. Click OK.

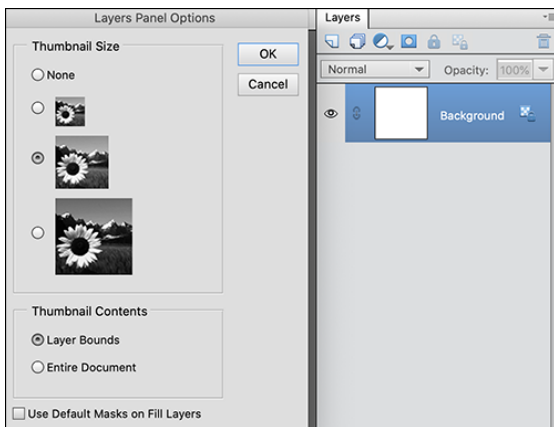

Move Tool Tool Options

- Get the Move tool.
- In the Tool Options, uncheck Auto Select Layer and check Show Bounding Box.

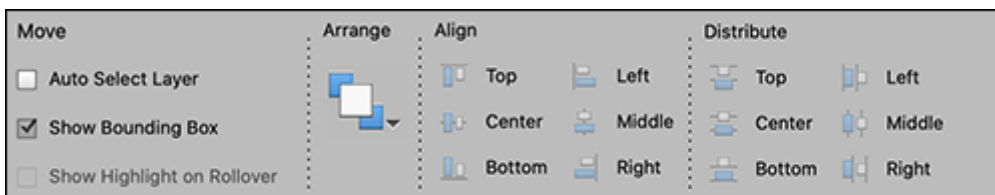

Preferences

- Press Ctrl K (Mac: Cmd K) to open Preferences.
- In General, leave all the settings as shown (they are default settings) except:
 - Check Disable Smart Objects.
 - Check Allow Floating Documents in Expert Mode.
 - Check Use Shift Key for Tool Switch.
 - Uncheck Select Move Tool After Committing Text
- Click OK to commit the changes.

General

Color Picker: Adobe

Step Back/Fwd: Cmd+Z / Cmd+Y

Options

- Show Tool Tips
- Disable Smart Objects
- Select Move tool after committing text
- Allow Floating Documents in Expert Mode
- Enable Floating Document Window Docking
- Use Shift Key for Tool Switch
- Zoom with Scroll Wheel
- Enable Soft Notifications
- Enable Crop Pre-Selection

General

Performance

Memory Usage

Available RAM: 29021 MB

Ideal Range: 15962-20895 MB

Let Photoshop Elements Use: 20315 MB (70%)

History & Cache

History States: 50

Cache Levels: 6

Graphics Processor Settings

Detected Graphics Processor:

ATI Technologies Inc.
AMD Radeon R9 M395 OpenGL Engine

Use Graphic Processor for improved performance

General

Scratch Disks

Active?	Drive	Free Space	Information
<input checked="" type="checkbox"/>	Macintosh HD	778.44GB	Startup
<input type="checkbox"/>	Elements	553.83GB	

General

Painting Cursors

Standard

Precise

Normal Brush Tip

Full Size Brush Tip

Show Crosshair in Brush Tip

Other Cursors

Standard

Precise

Crop Tool

Use Shield

Shield Color:

Opacity: 75%

General

Transparency Settings

Grid Size: Medium

Grid Colors: Light

General

Units

Rulers: Inches

Type: Points

Print Sizes: inches

Photo Project Units: inches

New Document Preset Resolutions

Adobe Partner Services
Application Updates
Type

Print Resolution: Pixels/Inch ▾
Screen Resolution: Pixels/Inch ▾

General
Saving Files
Performance
Scratch Disks
Display & Cursors
Transparency
Units & Rulers
Guides & Grid
Plug-Ins
Adobe Partner Services

Guides

Canvas: ▾ 

Style: ▾

Grid

Color: ▾ Gridline every: Inches ▾ 

Style: ▾ Subdivisions:

General
Saving Files
Performance
Scratch Disks
Display & Cursors
Transparency
Units & Rulers
Guides & Grid
Plug-Ins

Type Options

Use Smart Quotes
 Show Asian Text Options
 Enable Missing Glyph Protection
 Show Font Names in English
 Font Preview Size: ▾